

JDB Casting Bronze Cylindrical Bushings 圆柱型铜套

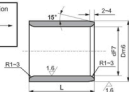

Material Specifications 材料

材料: 高力青铜
CuZn25Al5Mn4Fe3

How To Order 订单方式

Code d D L
● JDB 05 10 08

Housing Tolerance 相配孔径公差

相配孔径公差等级推荐H7
Housing tolerance recommended H7

I.D. ϕ d 内径 F7	O.D. ϕ D 外径 m6	L $\begin{smallmatrix} -0.1 \\ +0.3 \end{smallmatrix}$						
		8	10	12	15	16	19	20
6	10	●	●	●				
8	12	●	●		●			
10	14	●	●	●	●			●
12	18	●		●	●	●	●	●
13	19			●	●			●
14	20			●	●			●
15	21		●		●	●		●
16	22		●		●	●	●	●
17	23				●			
18	24		●		●	●		●
19	26				●			●
20	28				●	●	●	●
20	30				●	●		●
22	32		●		●	●		●
25	33				●	●		●
	35				●	●	●	●
28	38							●
30	40				●	●		●
32	42							●
35	44							●
	45							●
38	48							
40	50					●		●
	55					●		
45	56							
	60							

JDB Casting Bronze Cylindrical Bushings 圆柱型铜套



Mating Shaft
相配轴

d8: High load 高负荷
e7: Light load 轻负荷
f7: High precision 高精度



Mating Housing
相配座孔

Material Specifications 材料

材料: 高力黄铜
CuZn25Al5Mn4Fe3

How To Order 订单方式

Code d D L
● JDB 12 18 25

Housing Tolerance 相配座孔公差

相配座孔公差等级推荐H7
Housing tolerance recommended H7

Unit(单位): mm

L -0.1 -0.3								I.D. After Press-Fitting 压装后内孔	JTW (Washer) 透州垫片	I.D. ϕ d 内径
25	30	35	40	50	60	70	80	+0.019 +0.007	—	6
								+0.025 +0.019	—	8
●	●							+0.031 +0.013	10	10
●	●								12	12
●	●								13	13
●	●								14	14
●	●	●						+0.030 +0.012	15	15
●	●	●							16	16
									18	17
●	●	●							18	18
									20	19
●	●	●	●	●					20	20
●	●	●	●	●					20	
●	●	●	●	●					25	22
●	●	●	●	●	●				25	25
●	●	●	●	●	●				25	
●	●	●	●	●	●				30	28
●	●	●	●	●	●			+0.037 +0.016	30	30
●	●	●	●	●	●				30	
●	●	●	●	●	●				35	32
●	●	●	●	●	●				35	35
●	●	●	●	●	●				35	
									40	38
●	●	●	●	●	●	●	●		40	40
●	●	●	●	●	●	●	●		40	
									45	45
●	●	●	●	●	●			+0.045 +0.020	45	
●	●	●	●	●	●	●	●		45	

● 压入后内孔公差值仅供参考。
The ID tolerance after fitting is for reference.

JDB Casting Bronze Cylindrical Bushings 圆柱型铜套

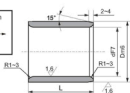

Material Specifications 材料

材料: 高力黄铜
CuZn25Al8Mn4Fe3

How To Order 订单方式

Code d D L
JDB 50 60 20

Housing Tolerance 相配孔径公差

相配孔径公差等级推荐H7
Housing tolerance recommended H7

I.D. ϕ d 内径 F7		O.D. ϕ D 外径 m6	L $\begin{smallmatrix} \pm 0.1 \\ \pm 0.3 \end{smallmatrix}$						
			20	30	35	40	50	60	70
50	+0.050 +0.025	60	●	●	●	●	●	●	●
		62		●	●	●	●	●	●
		65		●	●	●	●	●	●
55	+0.030 +0.011	70		●	●	●	●	●	●
		74		●	●	●	●	●	●
60	+0.060 +0.030	75		●	●	●	●	●	●
63						●	●	●	●
65						●	●	●	●
70			●	●		●	●	●	●
75						●	●	●	●
80	+0.035 +0.013	85		●	●		●	●	●
		90					●	●	●
		95					●	●	●
85	+0.071 +0.036	96				●	●	●	●
		100				●	●	●	●
90	+0.040 +0.015	110					●	●	
100							●	●	●
110							●		●
120									●
125	+0.083 +0.043	145							
130									
140									
150	+0.048 +0.017	160							
160									
170									
180									
190	+0.096 +0.050	190							
200									
200		230							

JDB Casting Bronze Cylindrical Bushings 圆柱型铜套



Mating Shaft
相配轴

d8: High load 高负荷
e7: Light load 轻负荷
f7: High precision 高精度



Mating Housing
相配座孔

Material Specifications 材料

材料: 高力黄铜
CuZn25Al8Mn4Fe3

How To Order 订单方式

Code d D L
● JDB 50 60 80

Housing Tolerance 相配座孔公差

相配座孔公差等级推荐H7
Housing tolerance recommended H7

Unit(单位): mm

L ^{+0.1} / _{-0.3}								I.D. After Press-Fitting 压装后内径	JTB (Washer 垫片)	I.D. ϕ d 内径
80	90	100	120	130	140	150	200			
●										
●								+0.040 +0.020	50	50
●		●							55	55
●										
●		●						+0.050 +0.030	60	60
●									65	63
●										65
●		●							70	70
●										
●		●						+0.054 +0.024	75	75
●										
●		●		●					80	80
●										
●		●		●				+0.065 +0.030	90	85
●										90
●	●	●	●	●					100	100
●		●						+0.064 +0.029	120	110
●										120
●		●		●						125
●										130
●										140
●		●						+0.076 +0.036		150
●							●			160
●		●								170
●										180
●		●								190
●								+0.088 +0.042		200

※压入后内孔公差值仅供参考。
The ID tolerance after fitting is for reference.