

SB-DIN9834 ISO9448 Oilless Guide Bushing 欧系标准汽车冲压模具导套

The Standard Identical with: VW/AUDI 39D90 CPEL U2802-95 BMW B2 293312082 70

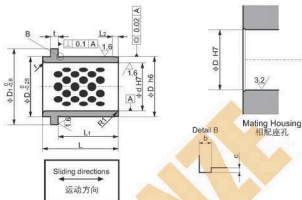

Material Specifications 材料

材料: 高力黄铜+固体润滑剂
CuZr25Al5Mn4Fe3+Graphite(500#SF)

How To Order 订单方式

Code d
● SB-SOST 025

Unit(单位): mm

SinoBronze Standard No.	d H7	D h6	L	D ₁	L ₁	L ₂	t	r	bxc	P	
● SB-DIN9834-025	25	+0.021 0	32	40	40	30	3	6.3	3	0.6 × 0.3	58
SB-DIN9834-032	32	40	50	50	40	4	66				
SB-DIN9834-040	40	+0.025 0	50	63	63	50	5				79
SB-DIN9834-050	50	63	71	71	56	6.3	10	5	1.0 × 0.4	89	
SB-DIN9834-063	63	80	90	90	63	8				123	
SB-DIN9834-080	80	+0.030 0	100	112	80	10				8	143
SB-DIN9834-100	100	125	125	140	106	12.5	12	10	1.0 × 0.4	168	
SB-DIN9834-125	125	+0.040 0	160	180	132	16				12	203
SB-DIN9834-160	160	200	220	220	170	16				18	243

Clamp VDI-KL (DIN9834 ISO9448) 压板

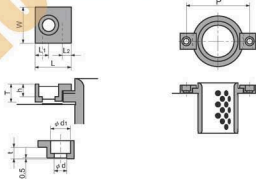

Material Specifications 材料

材料: 钢 C45
Material: Steel C45
Clamp ident. with DIN 9832

How To Order 订单方式

Code t
● VDI-KL 6

SinoBronze Standard No.	W	L	T	L ₁	L ₂	t	d	d ₁	h	Applicable bushes ID 适用的铅套内孔尺寸
● VDI-KL-6	20	20	10	7.5	5	6.3	7	11	7	φ25-φ50
VDI-KL-10	32	32	16	11	10	10	11.5	17.5	11.5	φ63-φ160

SB-SEGB, SB-SEGBK, Oilless Ejector Guide Bushing 塑胶模射出座导套

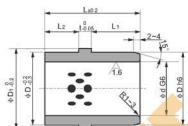

Material Specifications 材料

材料: 高力黄铜+固体润滑剂
CuZn25Al5Mn4Fe3 + Graphite(500#SP)

How To Order 订单方式

Code	d	L
● SB-SEGB	16	26
● SB-SEGBK	25	33

SinoBronze Standard No.	d	L	d G6	D h6	D ₁	L ₁	L ₂	t
SB-SEGB-1626	16	26						12
SB-SEGB-1628	16	28						14
SB-SEGB-1633	16	33	+0.017 +0.006	25		30		19
SB-SEGB-1638	16	38						24
SB-SEGB-2026	20	26			⁰ -0.013			12
SB-SEGB-2028	20	28						14
SB-SEGB-2033	20	33		30		35	10	19
SB-SEGB-2038	20	38						24
SB-SEGB-2526	25	26						12
SB-SEGB-2528	25	28	+0.020 +0.007	35		40		14
SB-SEGB-2533	25	33				40		19
SB-SEGB-2538	25	38						24
SB-SEGB-3033	30	33						14
SB-SEGB-3038	30	38		40	⁰ -0.016	45		19
SB-SEGB-3046	30	43						24
SB-SEGB-3533	35	33						19
SB-SEGB-3543	35	43		46		50	24	29
SB-SEGB-3544	35	44						29
SB-SEGB-4042	40	48	+0.025 +0.009	52		57		24
SB-SEGB-4053	40	53			⁰ -0.019	57		24
SB-SEGB-5048	50	48				67		29
SB-SEGB-5053	50	53						29

Unit(单位): mm

SinoBronze Standard No.	d	L	d G6	D h6	D ₁	L ₁	L ₂	t
SB-SEGBK-2533	25	33						19
SB-SEGBK-2538	25	38						24
SB-SEGBK-3046	30	46	+0.020 +0.007	40		45	11	24
SB-SEGBK-3047	30	47						24
SB-SEGBK-3052	30	52		42	⁰ -0.016	47	15	29
SB-SEGBK-3563	35	63		45		50	16	39
SB-SEGBK-4060	40	60						32
SB-SEGBK-4070	40	70						42
SB-SEGBK-4078	40	78		50		55	20	42
SB-SEGBK-4078	40	78						49
SB-SEGBK-4078	40	78						21
SB-SEGBK-4078	40	78						25
SB-SEGBK-4078	40	78	+0.025 +0.009	55		60	30	24
SB-SEGBK-4078	40	78						29
SB-SEGBK-4588	45	88		45		60	21	69
SB-SEGBK-4595	45	95			⁰ -0.019	67	30	69
SB-SEGBK-5067	50	67		62		67	30	29
SB-SEGBK-5067	50	67						39
SB-SEGBK-5067	50	67						30
SB-SEGBK-5067	50	67	+0.020 +0.010	74		82	30	39
SB-SEGBK-6067	60	67						40