

Spring Bushings with Wave-Shaped Slot

(Produced on Request)

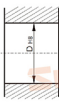

麻孔 Housing

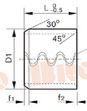

安装前 Bush before insertion

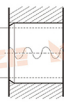

安装后 Bush inserted



轴 Shaft

d	D	D1	外径 O.D.	内径 I.D.	麻孔 Housing Bore (H8)	轴 Shaft (h8)	f ₁	f ₂	L -0.50												
14	20	20	20 +0.13 -0.03	20 +0.052	14 +0.11	20 +0.033	14 -0.016 -0.043	2.2	1	●	●	●	●								
15	20	20	20 +0.13 -0.03	20 +0.052	15 +0.11	20 +0.033	15 -0.016 -0.043	2.2	1	●	●	●	●								
16	22	22	22 +0.15 -0.05	22 +0.052	16 +0.11	22 +0.033	16 -0.016 -0.043	2.2	1	●	●	●	●								
18	24	24	24 +0.15 -0.05	24 +0.052	18 +0.11	24 +0.033	18 -0.016 -0.043	2.2	1	●	●	●	●								
20	25	25	25 +0.15 -0.05	25 +0.052	20 +0.13	25 +0.033	20 -0.02 -0.053	2.2	1	●	●	●	●								
22	28	28	28 +0.15 -0.05	28 +0.052	22 +0.13	28 +0.033	22 -0.02 -0.053	2.2	1	●	●	●	●								
24	30	30	30 +0.15 -0.05	30 +0.052	24 +0.13	30 +0.033	24 -0.02 -0.053	2.2	1	●	●	●	●								
25	32	32	32 +0.15 -0.05	32 +0.062	25 +0.13	32 +0.039	25 -0.02 -0.053	2.2	1	●	●	●	●								
28	35	35	35 +0.15 -0.05	35 +0.062	28 +0.13	35 +0.039	28 -0.02 -0.053	2.2	1	●	●	●	●								
30	38	38	38 +0.15 -0.05	38 +0.062	30 +0.13	38 +0.039	30 -0.02 -0.053	2.2	1	●	●	●	●								
32	40	40	40 +0.15 -0.05	40 +0.062	32 +0.16	40 +0.039	32 -0.025 -0.064	2.2	1	●	●	●	●								
35	44	44	44 +0.23 -0.07	44 +0.062	35 +0.16	44 +0.039	35 -0.025 -0.064	2.2	1	●	●	●	●								
36	45	45	45 +0.23 -0.07	45 +0.062	36 +0.16	45 +0.039	36 -0.025 -0.064	2.2	1												
38	48	48	48 +0.23 -0.07	48 +0.062	38 +0.16	48 +0.039	38 -0.025 -0.064	2.2	1	●	●	●	●								
40	50	50	50 +0.23 -0.07	50 +0.062	40 +0.16	50 +0.039	40 -0.025 -0.064	2.6	1												
42	52	52	52 +0.23 -0.07	52 +0.074	42 +0.16	52 +0.045	42 -0.025 -0.064	2.6	1												
45	55	55	55 +0.23 -0.07	55 +0.074	45 +0.16	55 +0.045	45 -0.025 -0.064	2.6	1												
48	58	58	58 +0.23 -0.07	58 +0.074	48 +0.16	58 +0.045	48 -0.025 -0.064	2.6	1												
50	60	60	60 +0.23 -0.07	60 +0.074	50 +0.16	60 +0.045	50 -0.025 -0.064	2.6	1												
52	60	60	60 +0.23 -0.07	60 +0.074	52 +0.19	60 +0.045	52 -0.03 -0.076	2.6	1												
55	65	65	65 +0.23 -0.07	65 +0.074	55 +0.19	65 +0.045	55 -0.03 -0.076	2.6	1												
60	70	70	70 +0.23 -0.07	70 +0.074	60 +0.19	70 +0.045	60 -0.03 -0.076	2.6	1												
65	75	75	75 +0.23 -0.07	75 +0.074	65 +0.19	75 +0.045	65 -0.03 -0.076	2.6	1												
70	80	80	80 +0.23 -0.07	80 +0.074	70 +0.19	80 +0.045	70 -0.03 -0.076	3.2	1												
75	85	85	85 +0.3 -0.1	85 +0.087	75 +0.19	85 +0.054	75 -0.03 -0.076	3.2	1												
80	90	90	90 +0.3 -0.1	90 +0.087	80 +0.19	90 +0.054	80 -0.03 -0.076	3.2	1												
85	95	95	95 +0.3 -0.1	95 +0.087	85 +0.22	95 +0.054	85 -0.036 -0.09	3.2	1												
90	100	100	100 +0.3 -0.1	100 +0.087	90 +0.22	100 +0.054	90 -0.036 -0.09	3.2	1												
95	105	105	105 +0.3 -0.1	105 +0.087	95 +0.22	105 +0.054	95 -0.036 -0.09	3.2	1												
100	115	115	115 +0.3 -0.1	115 +0.087	100 +0.22	115 +0.054	100 -0.036 -0.09	3.2	1												
105	115	115	115 +0.3 -0.1	115 +0.087	105 +0.22	115 +0.054	105 -0.036 -0.09	3.2	1												

Notes: * Standard material: hardened spring steel - AISI6150, 50CrV4 (DIN1.8159), SUP 10, 50CrVA, CK67, 65 Mn --etc.

* All sizes are in Metric " mm ".

* Speical dimenions and toleranes are made to customer' request.

* Surface treatment is optional: Zinc plating / Phosphate coating ; Tin plating.