

## DX Cylindrical Bushes, Standard Metric Sizes List

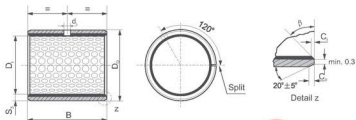

SINOBRONZE



ID and OD chamfers

S <sub>1</sub>	C <sub>0</sub>	C	β	S <sub>1</sub>	C <sub>0</sub>	C	β
1.0	0.6±0.3	0.30±0.2	30° ±5°	2.0	1.2±0.4	0.50±0.3	30° ±5°
1.5	0.7±0.3	0.50±0.2	30° ±5°	2.5	1.8±0.6	0.80±0.3	45° ±5°

Unit:mm

Shaft D <sub>s</sub> h8	Housing H7 D <sub>h</sub>	OD tolerance D <sub>o</sub>	ID after fixed D <sub>i</sub>	Clearance C <sub>o</sub>	Wall thickness S <sub>1</sub>	Oil hole d <sub>o</sub>	B <sup>0</sup> <sub>-0.40</sub>																	
							10	15	20	25	30	35	40	45	50	60								
10 <sup>+0.022</sup> <sub>-0.022</sub>	12 <sup>+0.018</sup> <sub>-0.018</sub>	12 <sup>+0.065</sup> <sub>-0.030</sub>	10.108 10.040	0.130 0.040	0.980 0.955	4	MB 1010DX	MB 1015DX	MB 1020DX															
12 <sup>+0.027</sup> <sub>-0.027</sub>	14 <sup>+0.018</sup> <sub>-0.018</sub>	14 <sup>+0.065</sup> <sub>-0.030</sub>	12.108 12.040						MB 1210DX	MB 1215DX	MB 1220DX													
14 <sup>+0.027</sup> <sub>-0.027</sub>	16 <sup>+0.018</sup> <sub>-0.018</sub>	16 <sup>+0.065</sup> <sub>-0.030</sub>	14.108 14.040	0.135 0.040					MB 1415DX	MB 1420DX														
15 <sup>+0.027</sup> <sub>-0.027</sub>	17 <sup>+0.018</sup> <sub>-0.018</sub>	17 <sup>+0.065</sup> <sub>-0.030</sub>	15.108 15.040						MB 1515DX	MB 1520DX	MB 1525DX													
16 <sup>+0.027</sup> <sub>-0.027</sub>	18 <sup>+0.018</sup> <sub>-0.018</sub>	18 <sup>+0.065</sup> <sub>-0.030</sub>	16.108 16.040						MB 1615DX	MB 1620DX	MB 1625DX													
18 <sup>+0.027</sup> <sub>-0.027</sub>	20 <sup>+0.021</sup> <sub>-0.021</sub>	20 <sup>+0.075</sup> <sub>-0.035</sub>	18.111 18.040	0.138 0.040					MB 1815DX	MB 1820DX														
20 <sup>+0.033</sup> <sub>-0.033</sub>	23 <sup>+0.021</sup> <sub>-0.021</sub>	23 <sup>+0.075</sup> <sub>-0.035</sub>	20.131 20.050				1.475 1.445	6	MB 2015DX	MB 2020DX	MB 2025DX	MB 2030DX												
22 <sup>+0.033</sup> <sub>-0.033</sub>	25 <sup>+0.021</sup> <sub>-0.021</sub>	25 <sup>+0.075</sup> <sub>-0.035</sub>	22.131 22.050	0.164 0.050							MB 2215DX	MB 2225DX												
25 <sup>+0.033</sup> <sub>-0.033</sub>	28 <sup>+0.021</sup> <sub>-0.021</sub>	28 <sup>+0.075</sup> <sub>-0.035</sub>	25.131 25.050								MB 2515DX	MB 2520DX	MB 2525DX	MB 2530DX										
28 <sup>+0.033</sup> <sub>-0.033</sub>	32 <sup>+0.025</sup> <sub>-0.025</sub>	32 <sup>+0.085</sup> <sub>-0.045</sub>	28.155 28.060	0.188 0.060			1.970 1.935	8	MB 2820DX	MB 2830DX														
30 <sup>+0.033</sup> <sub>-0.033</sub>	34 <sup>+0.025</sup> <sub>-0.025</sub>	34 <sup>+0.085</sup> <sub>-0.045</sub>	30.155 30.060								MB 3030DX	MB 3025DX	MB 3030DX		MB 3040DX									
35 <sup>+0.039</sup> <sub>-0.039</sub>	39 <sup>+0.025</sup> <sub>-0.025</sub>	39 <sup>+0.085</sup> <sub>-0.045</sub>	35.155 35.060	0.194 0.060							MB 3520DX	MB 3530DX	MB 3535DX	MB 3540DX										
40 <sup>+0.039</sup> <sub>-0.039</sub>	44 <sup>+0.025</sup> <sub>-0.025</sub>	44 <sup>+0.085</sup> <sub>-0.045</sub>	40.155 40.060						MB 4020DX	MB 4030DX		MB 4040DX									MB 4050DX			
45 <sup>+0.039</sup> <sub>-0.039</sub>	50 <sup>+0.025</sup> <sub>-0.025</sub>	50 <sup>+0.085</sup> <sub>-0.045</sub>	45.195 45.080	0.234 0.080					MB 4520DX	MB 4530DX	MB 4540DX	MB 4545DX	MB 4550DX											
50 <sup>+0.039</sup> <sub>-0.039</sub>	55 <sup>+0.030</sup> <sub>-0.030</sub>	55 <sup>+0.100</sup> <sub>-0.055</sub>	50.200 50.080	0.239 0.080	2.460 2.415	8			MB 5030DX	MB 5040DX		MB 5050DX	MB 5060DX											
55 <sup>+0.046</sup> <sub>-0.046</sub>	60 <sup>+0.030</sup> <sub>-0.030</sub>	60 <sup>+0.100</sup> <sub>-0.055</sub>	55.200 55.080						MB 5530DX	MB 5540DX		MB 5550DX	MB 5560DX											
60 <sup>+0.046</sup> <sub>-0.046</sub>	65 <sup>+0.030</sup> <sub>-0.030</sub>	65 <sup>+0.100</sup> <sub>-0.055</sub>	60.200 60.080	0.246 0.080					MB 6030DX	MB 6040DX		MB 6050DX	MB 6060DX											

## DX Cylindrical Bushes, Standard Metric Sizes List

Unit:mm

Shaft D <sub>s</sub> h8	Housing H7 D <sub>h</sub>	OD tolerance D <sub>0</sub>	ID after fixed D <sub>1</sub>	Clearance C <sub>0</sub>	Wall thickness S <sub>1</sub>	Oil hole d <sub>1</sub>	B <sup>0</sup> <sub>-0.40</sub>													
							40	50	60	80	90	95	100	110	120					
65 <sup>-0.046</sup>	70 <sup>+0.030</sup>	70 <sup>+0.100 +0.065</sup>	65.200 65.090	0.246 0.080	2.460 2.415	8	MS 8540DX	MS 8560DX												
70 <sup>-0.046</sup>	75 <sup>+0.030</sup>	75 <sup>+0.100 +0.065</sup>	70.200 70.090				MS 7540DX	MS 7560DX	MS 7580DX											
75 <sup>-0.046</sup>	80 <sup>+0.030</sup>	80 <sup>+0.100 +0.065</sup>	75.200 75.090				MS 7540DX	MS 7560DX	MS 7580DX											
80 <sup>-0.046</sup>	85 <sup>+0.035</sup>	85 <sup>+0.120 +0.070</sup>	80.265 80.100	0.313 0.100			MS 8540DX	MS 8560DX	MS 8580DX											
85 <sup>-0.054</sup>	90 <sup>+0.035</sup>	90 <sup>+0.120 +0.070</sup>	85.265 85.100				MS 8540DX	MS 8560DX	MS 8580DX											
90 <sup>-0.054</sup>	95 <sup>+0.035</sup>	95 <sup>+0.120 +0.070</sup>	90.265 90.100				MS 9040DX	MS 9060DX	MS 9080DX	MS 9090DX										
100 <sup>-0.054</sup>	105 <sup>+0.035</sup>	105 <sup>+0.120 +0.070</sup>	100.265 100.100	0.321 0.100			MS 10550DX	MS 10590DX	MS 10630DX	MS 10695DX										
105 <sup>-0.054</sup>	110 <sup>+0.035</sup>	110 <sup>+0.120 +0.070</sup>	105.265 105.110				MS 10550DX	MS 10590DX	MS 10630DX	MS 10695DX	MS 10710DX									
110 <sup>-0.054</sup>	115 <sup>+0.035</sup>	115 <sup>+0.120 +0.070</sup>	110.265 110.110				MS 11050DX	MS 11090DX	MS 11130DX	MS 11095DX	MS 11110DX	MS 11115DX								
120 <sup>-0.054</sup>	125 <sup>+0.040</sup>	125 <sup>+0.170 +0.160</sup>	120.270 120.110	0.324 0.110	2.450 2.385		MS 12500DX	MS 12540DX	MS 12580DX											
125 <sup>-0.063</sup>	130 <sup>+0.040</sup>	130 <sup>+0.170 +0.160</sup>	125.270 125.110				MS 13550DX	MS 13600DX	MS 13650DX	MS 13610DX	MS 13615DX									
130 <sup>-0.063</sup>	135 <sup>+0.040</sup>	135 <sup>+0.170 +0.160</sup>	130.270 130.110				MS 14550DX	MS 14600DX	MS 14650DX	MS 14610DX	MS 14615DX									
140 <sup>-0.063</sup>	145 <sup>+0.040</sup>	145 <sup>+0.170 +0.160</sup>	140.270 140.110	0.339 0.110			MS 15550DX	MS 15600DX	MS 15650DX	MS 15610DX										
150 <sup>-0.063</sup>	155 <sup>+0.040</sup>	155 <sup>+0.170 +0.160</sup>	150.270 150.110				MS 16550DX	MS 16600DX	MS 16650DX	MS 16610DX	MS 16615DX									
160 <sup>-0.063</sup>	165 <sup>+0.040</sup>	165 <sup>+0.170 +0.160</sup>	160.270 160.110				MS 17550DX	MS 17600DX	MS 17650DX	MS 17610DX	MS 17615DX									
170 <sup>-0.063</sup>	175 <sup>+0.040</sup>	175 <sup>+0.170 +0.160</sup>	170.270 170.110	0.339 0.110			MS 18550DX	MS 18600DX	MS 18650DX	MS 18610DX										
180 <sup>-0.063</sup>	185 <sup>+0.046</sup>	185 <sup>+0.210 +0.130</sup>	180.276 180.110				MS 19550DX	MS 19600DX	MS 19650DX	MS 19610DX	MS 19615DX	MS 19620DX								
190 <sup>-0.072</sup>	195 <sup>+0.046</sup>	195 <sup>+0.210 +0.130</sup>	190.276 190.110				MS 20550DX	MS 20600DX	MS 20650DX	MS 20610DX	MS 20615DX	MS 20620DX								
200 <sup>-0.072</sup>	205 <sup>+0.046</sup>	205 <sup>+0.210 +0.130</sup>	200.276 200.110	0.354 0.110			MS 21550DX	MS 21600DX	MS 21650DX	MS 21610DX										
220 <sup>-0.072</sup>	225 <sup>+0.046</sup>	225 <sup>+0.210 +0.130</sup>	220.276 220.110				MS 22550DX	MS 22600DX	MS 22650DX	MS 22610DX	MS 22615DX	MS 22620DX								
240 <sup>-0.072</sup>	245 <sup>+0.046</sup>	245 <sup>+0.210 +0.130</sup>	240.276 240.110				MS 24550DX	MS 24600DX	MS 24650DX	MS 24610DX	MS 24615DX	MS 24620DX								
250 <sup>-0.072</sup>	255 <sup>+0.052</sup>	255 <sup>+0.260 +0.170</sup>	250.282 250.110	0.354 0.110			MS 25550DX	MS 25600DX	MS 25650DX	MS 25610DX										
260 <sup>-0.081</sup>	265 <sup>+0.052</sup>	265 <sup>+0.260 +0.170</sup>	260.282 260.110				MS 26550DX	MS 26600DX	MS 26650DX	MS 26610DX	MS 26615DX	MS 26620DX								
280 <sup>-0.081</sup>	285 <sup>+0.052</sup>	285 <sup>+0.260 +0.170</sup>	280.282 280.110				MS 28550DX	MS 28600DX	MS 28650DX	MS 28610DX	MS 28615DX	MS 28620DX								
300 <sup>-0.081</sup>	305 <sup>+0.052</sup>	305 <sup>+0.260 +0.170</sup>	300.282 300.110				MS 30550DX	MS 30600DX	MS 30650DX	MS 30610DX										